



# TECHNICAL INFORMATION

## COLOR OPTIONS

### Vinyl Options



White

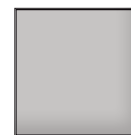

Dove Gray

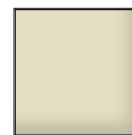

Champagne

### Steel Options



White



Saddle Tan

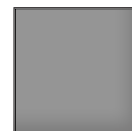

Gray

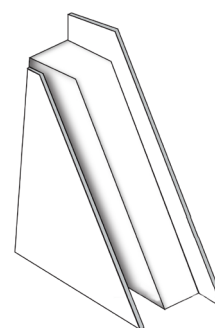

**G/G**



**S/S**

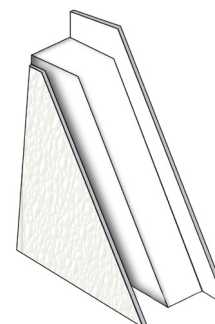

**FRP/FRP**

WALL	INTERIOR & EXTERIOR SURFACE	STC Rating	BENEFITS
<b>G/G</b>	4-mil vinyl laminated to 1/2" type X fire rated Gypsum (x2)	30	Price efficient. Good for insulation. Plus sound and fire resistance
<b>GSB/SBG</b>	1/2" Vinyl Covered Gypsum (x2) 1/2" SoundStop Board	40-42	Same as above with increased rigidity and sound proofing
<b>G/G Ballistic</b>	1/2" gypsum (x2) Ballistic fiberglass (thickness varies based upon ballistic rating level)	30	Great for office space in high risk environments
<b>S/S</b>	26 gauge stucco-embossed steel (x2)	26	Highly durable. Handles harsh conditions and easily cleaned
<b>S/G</b>	26 gauge stucco-embossed steel 1/2" Vinyle Covered Gypsum	28	Durable exterior for offices placed in harsh environments
<b>SB/BS</b>	26 guard stucco-embossed steel to 1/8" hard board (x2)	28	Our strongest steel panel, holds up against the worst environments
<b>SG/GS</b>	26 gague stucco-embossed steel to 1/2" gypsum board (x2)	32	Durable with great insulation and sound resistance
<b>SG/GS</b>	26 gague stucco-embossed steel to 1/2" gypsum board (x2) 2" mineral wool core	35-42	Same as above with increased fire protection
<b>1 HR Fire Rated</b>	26 gauge stucco embossed steel to 5/8" gypsum panel 2" mineral wool core	35-42	Able to withstand an open flame for up to an hour while hold its structural integrity
<b>S/FRP</b>	26 gauge stucco embossed steel .090 stucco embossed fiberglass reinforced plastic	26	Durable exterior and easily cleaned inside and out. Great for exterior bathrooms
<b>FRP/FRP</b>	.090 stucco embossed fiberglass reinforced plastic (x2)	26	Impact/scratch resistant, easy to clean, USDA approved and does not support mold or mildew growth
<b>FRP/G</b>	.090 Stucco embossed fiberglass reinforced plastic to 1/2" vinyl covered gypsum board	28	Great for an internal bathroom area which shares a wall with an office.
<b>FRP-B/B-FRP</b>	.090 stucco embossed fiberglass reinforced plastic to 1/8" hard-board (x2)	28	Same as above. More rigidity and soundproofing

\*All panels mentioned above come equipped with either polystyrene or poly-iso cores, unless noted other-

\*STC ratings are approximations based upon industry standards.

Do not worry about painting again when you use our commercial grade vinyl coated gypsum wall panels. Constructed to ensure fire and sound control, these 3" thick walls are perfect for offices for light duty warehouse or moderate industrial applications.

Panel Built's high performance modular wall panels provide higher quality facings to complete a 3" wall thickness, providing premium performance in structural capabilities, fire ratings, sound deadening, thermal insulation,